

## ENERGY EFFICIENCY

Thermal Transmission Coefficient  
 **$U_w \geq 0.81$  (W/m<sup>2</sup>K)**

Please consult typology, dimensions and glazing.

## ACCOUSTIC INSULATION

Maximum glazing: **40 mm**  
 Maximum acoustic insulation: **Rw = 46 dB**

## CATEGORIES ACHIEVED AT TEST CENTRE

Protection against atmospheric agents

Air permeability (EN 12207):

**Class 4**

Water tightness (EN 12208):

**Class E1650**

Wind resistance (EN 12210):

**Class C5**

Reference test 1.23 x 1.48 m / 1 Sash

Security Test: **PAS24**

**Passed**

Reference test 1.100 x 2.400 m / 1 sash

<b>SECTIONS</b>	Frame 70 mm Sash 70 mm	<b>EXTRUSION ALLOY</b>	6063 T-5
<b>PROFILE THICKNESS</b>	Window 1.9 mm	<b>POLYAMIDE STRIP LENGTH</b>	Polyamide 6.6 reinforced with 25% fiberglass: 35 mm
<b>MAXIMUM DIMENSIONS</b>	Standard solution Width (L) = 1.300 mm Height (H) = 2.400 mm  HD Hinges (side hung) Width (L) = 1.200 mm Height (H) = 3.500 mm	<b>GASKETS</b>	EPDM triple gasket
<b>MAXIMUM WEIGHT/SASH</b>	160 Kg	<b>FOAMS</b>	Perimeter polyolefin foam in glazing rebate zone
Please consult maximum dimensions according to types.		<b>OPENING POSSIBILITIES</b>	<b>INWARD</b>   Side hung, tilt and turn&tilt
<b>FINISHES</b>	Colour powder coating (RAL, mottled, rough...) According to Qualicoat >60 microns Wood effect powder coating According to Qualideco standard Anodized According to Ewwa Euras Standard Class 15 Optionally Class 20 and 25 Optionally bicoloured	<b>CERTIFICATES</b>	DTA certification from CSTB lab.  Certification - 3204

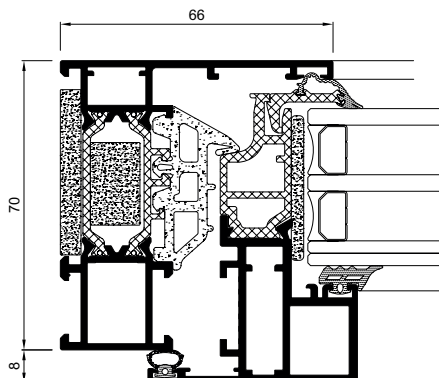

## ENERGY EFFICIENCY

Thermal Transmission Coefficient  
**Uw ≥ 0.82 (W/m²K)**

Please consult typology, dimensions and glazing.

## ACCOUSTIC INSULATION

Maximum glazing: **55 mm**  
Maximum acoustic insulation: **Rw = 44 dB**

## CATEGORIES ACHIEVED AT TEST CENTRE

Protection against atmospheric agents

Air permeability (EN 12207:

**Class 4**

Water tightness (EN 12208):

**Class E1800**

Wind resistance (EN 12210):

**Class C5**

Reference test 1.23 x 1.48 m / 2 sashes

SECTIONS	Frame 70 mm Sash 78 mm
PROFILE THICKNESS	Window 1.5 mm
MAXIMUM DIMENSIONS	Width (L) = 1000 mm Height (H) = 1700mm
MAXIMUM WEIGHT/SASH	160 Kg

Please consult maximum dimensions according to types.

FINISHES	<p>Colour powder coating (RAL, mottled, rough...) According to Qualicoat &gt;60 microns</p> <p>Wood effect powder coating According to Qualideco standard</p> <p>Anodized According to Ewwa Euras Standard Class 15 Optionally Class 20 and 25</p> <p>Optionally bicoloured</p>
----------	---

EXTRUSION ALLOY	6063 T-5
POLYAMIDE STRIP LENGTH	Polyamide 6.6 reinforced with 25% fiberglass: 32-35 mm
GASKETS	EPDM triple gasket
FOAMS	Perimeter polyolefin foam in glazing rebate zone
OPENING POSSIBILITIES	INWARD   Side hung, tilt and turn&tilt
CERTIFICATES	<p>DTA certification from CSTB lab.</p> <p>Certification - 3204</p>

